

## Installation of Soil System

As the Brett Martin Cast Iron Style Soil system is a coated version of the standard range, fixing instructions are predominately the same, details of which are available in the Brett Martin technical brochure, available on request.

However, due to the special coating, it is not possible to solvent weld any pipe and fittings together, which has dictated the selected range of fittings offered.

To maximise the traditional appearance of the range, special shrouds have been developed to fit around sockets to give a full cast iron socket effect. 2.5m socketed pipes are offered and a clip should be placed around each pipe socket to secure the stack to the wall. A lugged shroud (code BSS1LCI) can then be fitted over the clip and socket. Plain Socket Shrouds (code BSS2CI) can then be fitted over all other plain sockets to complete the full traditional appearance.

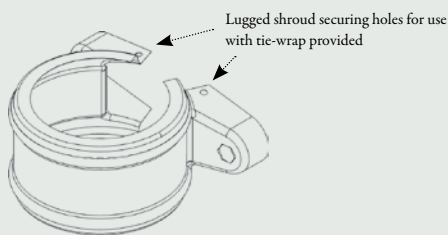

### Lugged Soil 'Shroud' (BSS1LCI) Fitting Instructions

1. Orientate the shroud so that the securing holes cannot be seen from eye level then snap shroud into position

The shroud should be fitted so that the underside face of the shroud is located against the top face of the clipped socketed pipe

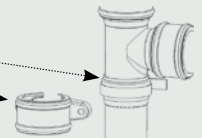

2. Thread the tie-wrap provided through the securing holes and tighten until shroud grips and the lugs fit back to the wall

Pulling each ear away from the wall to feed the tie wrap through each securing hole will aid fitting

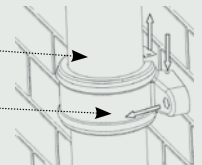

3. Repeat the above procedure on all clipped pipe fixings points

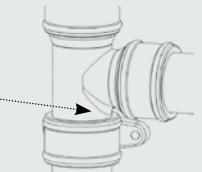

To connect Waste pipes to the stack, fit the relevant rubber Waste adaptor, (codes BW1, 2 or 3), into the relevant boss upstand and push the lubricated Waste pipe spigot fully into the adaptor.

When installing a soil stack, it is essential that all spigots are lubricated prior to being inserted into the lubricated ring seal joint and that an expansion allowance of 10mm is provided. Simply push the lubricated spigot fully into the socket, lightly mark the spigot and then withdraw the spigot 10mm.

**Care should be taken to prevent lubricant from staining the surface of the pipework during installation. We strongly recommend the use of our water based lubricant, code B9333, which is easily removable with soap and water should the surface appearance be affected.**

To form an offset in the Soil stack, use the Offset Pipe (code BS500CI) to form the relevant offset length between two relevant bends and coupler, if required. This negates the need to cut a full length of pipe and reduces the cost of the installation.

Care should be taken to ensure a vertical installation of the main stack for both appearance and to ensure suitable falls can be obtained for any connecting pipework.

Read the label inside the plain shroud to identify the fitting side and the pipe side

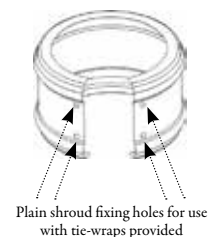

### Plain Soil 'Shroud' (BSS2CI) Fitting Instructions

1. Snap shroud into position ensuring that the shroud is correctly orientated

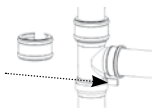

2. Spin the plain shroud so that the securing holes face you



3. Thread the tie-wraps provided through the securing holes and tighten until shroud grips the fitting and pipe

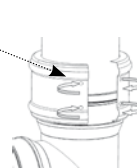

Ensure that the shroud is in the correct orientation and positioned against the upstand as shown

4. Spin the plain shroud back into position so the tie wrap is hidden

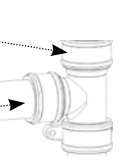

Repeat the above for every plain shroud